

## AUTOMATIC DRAIN

### SPECIFICATION

DESCRIPTION	TYPE	D704A
PORT SIZE(PT,NPT)		1 / 2"
MAX INPUT PRESSURE		225 PSI
OPERATING TEMP RANGE		5°C ~ 60°C
DRAIN CAPACITY		27ml

### FEATURES

- ◎ High inlet pressure support
- ◎ Longer life time
- ◎ Auto Drain design
- ◎ Manual Drain as back up design
- ◎ Application --- any end of pipe system

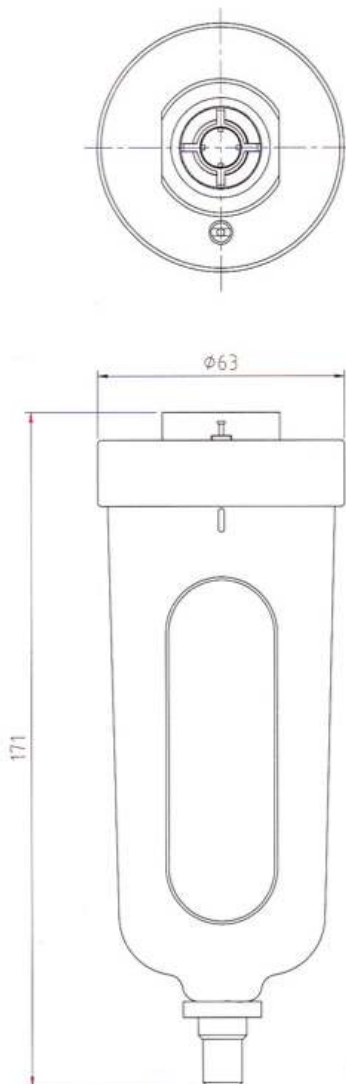

**D704A**

## AIRCLEN/DRYER

### SPECIFICATION

DESCRIPTION	TYPE	F-LM863
		FM863
		LM863
PORT SIZE (PT, NPT)		3/8"
FILTER ELEMENT		0.01μ
MAX SERVICE PRESSURE		150 PSI
MAX FLOW (l/min)		3000

### ORDER EXAMPLE

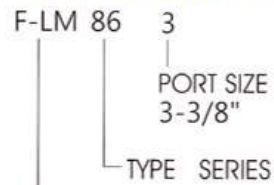

AIR CLEAN/DRYER COMBINATION

### Clean Air System

- \*Removes water vapor at the point of use
- \*Desiccant changes color when it needs to be changed or recharged
- \*Outlet screen keeps desiccant particles out of tools
- \*Oil-Removal filter removes 99.9% of all oil aerosols
- \*Clear bowl with metal guards for easy viewing of fluid level and impact protection
- \*Quick release bowl, and quarter turn drain for easy maintenance
- \*The red service Indicator rise when filter element needs to be changed

### Use of dryers can:

- 1.Reduce rust and pipe sludge,which can shorten component life,clog air lines and reduce air flow.
- 2.Prevent surface blemishes and poor paint adhesion due to water contamination.
- 3.Extend air tool life and improve performance.
- 4.Keep sandblasters from clogging.



F-LM86

Desiccant



FM86



LM86



### SPECIFICATION



DESCRIPTION		TYPE	
		C201	C202
PORT SIZE (PT,NPT)		1/8"	1/4"
FILTER ELEMENT		5μ	
MAX INPUT PRESSURE (PSI)		150	
MAX OUTPUT PRESSURE (PSI)		7~140	
MAX FLOW (l/min)		1000	1100
OPERATING TEMP RANGE		5°C~60°C	
DRAIN CAPACITY		15 ml	
OIL CAPACITY		30 ml	
RECOMMENDABLE LUBRICANTS		ISO VG-32	
TYPE OF CONSTITUTION UNIT	AIR FILTER	F201	F202
	REGULATOR	R201	R202
	LUBRICATOR	L201	L202

### ORDER EXAMPLE

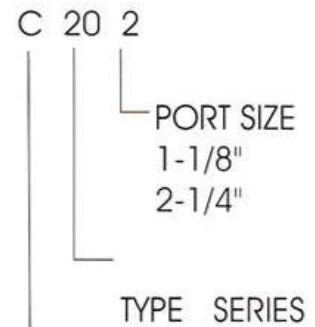

F.R.L. COMBINATION

### FEATURES

- ◎ Compact design for space saving and reduce installation time
- ◎ Economic choice.
- ◎ Application --- space is limited and low flow requirement.

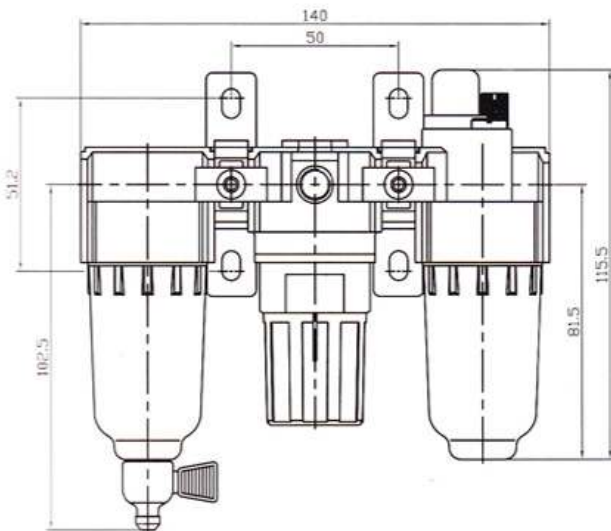
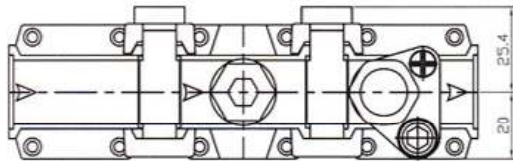

C20

## F.R.L COMBINATIONS

### SPECIFICATION

DESCRIPTION \ TYPE		FRL201	FRL202	FRL212
		PORT SIZE (PT,NPT)	1/8"	1/4"
FILTER ELEMENT		5μ		
MAX INPUT PRESSURE (PSI)		150		280
MAX OUTPUT PRESSURE (PSI)		7~140		7~227
MAX FLOW (l/min)		1000	1100	1100
OPERATING TEMP RANGE		5°C~60°C		
DRAIN CAPACITY		15 ml		
OIL CAPACITY		30 ml		
RECOMMENDABLE LUBRICANTS		ISO VG-32		
TYPE OF CONSTITUTION UNIT	AIR FILTER REGULATOR	FR201	FR202	FR212
	LUBRICATOR	L201	L202	L212

### ORDER EXAMPLE

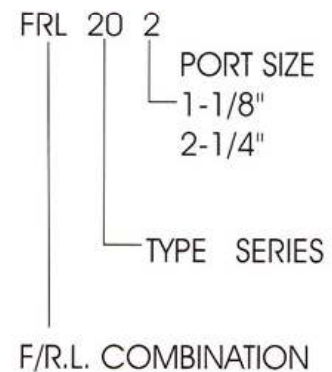

### FEATURES

- ⊙ Compact design for space saving and reduce installation time
- ⊙ Economic choice.
- ⊙ Application --- space is limited and flow requirement .

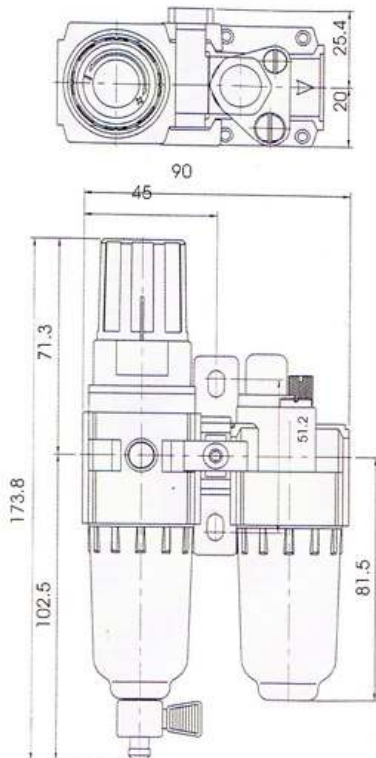

FRL202



FR20

SPECIFICATION



DESCRIPTION \ TYPE		C502	C503	C504
PORT SIZE (PT, NPT)		1/4"	3/8"	1/2"
FILTER ELEMENT		5μ		
MAX INPUT PRESSURE (PSI)		215		
MAX OUTPUT PRESSURE (PSI)		7~150		
MAX FLOW (l/min)		2200	3000	3100
OPERATING TEMP RANGE		5°C~60°C		
DRAIN CAPACITY		55 ml		
OIL CAPACITY		80 ml		
RECOMMENDABLE LUBRICANTS		ISO VG-32		
TYPE OF CONSTITUTION UNIT	AIR FILTER	F502	F503	F504
	REGULATOR	R502	R503	R504
	LUBRICATOR	L502	L503	L504

### ORDER EXAMPLE

C 50 3 - A  
 C: F.R.L COMBINATION  
 50: PORT SIZE  
 3: PORT SIZE  
 A: TYPE SERIES  
 AUTO DRAINAGE (OPTION)  
 2-1/4"  
 3-3/8"  
 4-1/2"

### FEATURES

- ◎ Steel Bowl Guard design as protection
- ◎ Buckle design for lockable protection

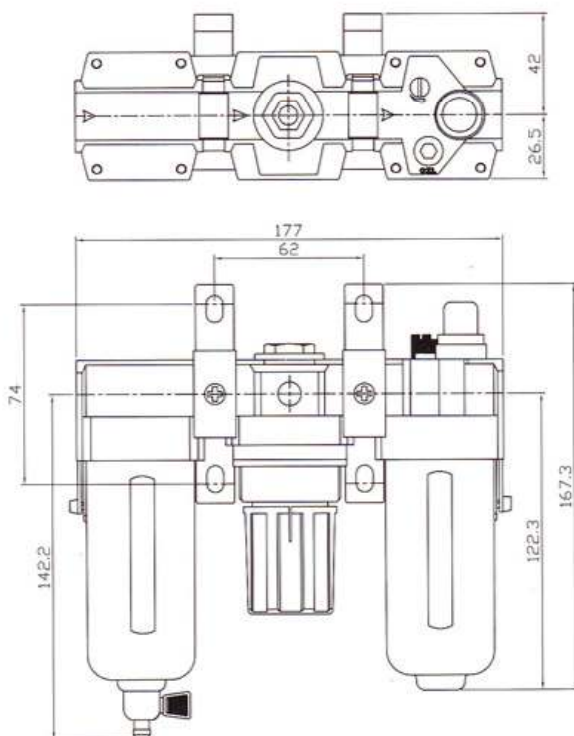

C50

# F.R.L COMBINATIONS

SPECIFICATION **CE**

DESCRIPTION		TYPE		
		FRL502	FRL503	FRL504
PORT SIZE (PT, NPT)		1/4"	3/8"	1/2"
FILTER ELEMENT		5μ		
MAX INPUT PRESSURE (PSI)		215		
MAX OUTPUT PRESSURE (PSI)		7~150		
MAX FLOW (l/min)		2200	3000	3100
OPERATING TEMP RANGE		5°C~60°C		
DRAIN CAPACITY		55 ml		
OIL CAPACITY		80 ml		
RECOMMENDABLE LUBRICANTS		ISO VG-32		
TYPE OF CONSTITUTION UNIT	FILTER/REGULATOR	FR502	FR503	FR504
	LUBRICATOR	L502	L503	L504

## ORDER EXAMPLE

FRL 50 3 - A  
 |  
 | AUTO DRAINAGE (OPTION)  
 | PORT SIZE  
 | 2-1/4"  
 | 3-3/8"  
 | 4-1/2"  
 | TYPE SERIES  
 F/R.L.COMBINATION

## FEATURES

- ◎ Steel Bowl Guard design as protection
- ◎ Buckle design for lockable protection

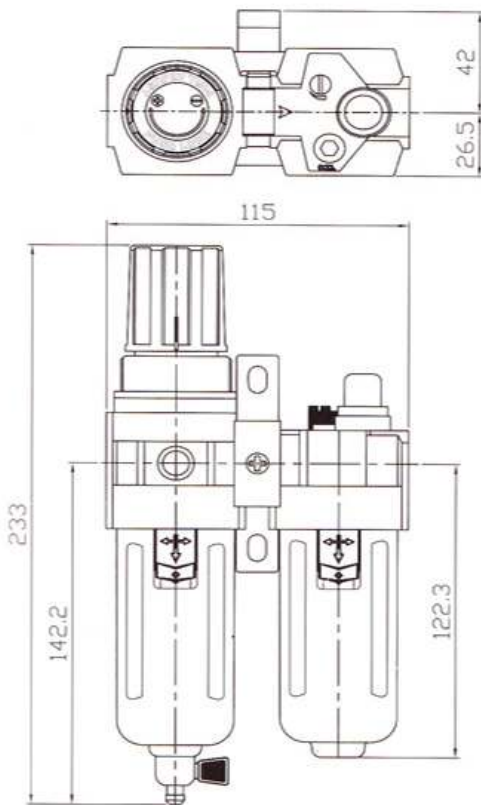

**FRL50**



**FR50**

### SPECIFICATION



DESCRIPTION \ TYPE	C706	F706	C704	F704
	R706	L706	R704	L704
PORT SIZE (PT, NPT)	3/4"		1/2"	
ADJ PRESSURE RANGE (PSI)	250			
MAX SERVICE PRESSURE (PSI)	215			
MAX FLOW (l/min)	5200		4600	
OPERATING TEMP RANGE	5°C ~ 60°C			
DRAIN CAPACITY	80 ml			
OIL CAPACITY	150 ml			
RECOMMENDABLE LUBRICANTS	ISO VG-32			
FILTER ELEMENT	5 μ			
TYPE OF CONSTITUTION UNIT	AIR FILTER / REGULATOR / LUBRICATOR			

### ORDER EXAMPLE

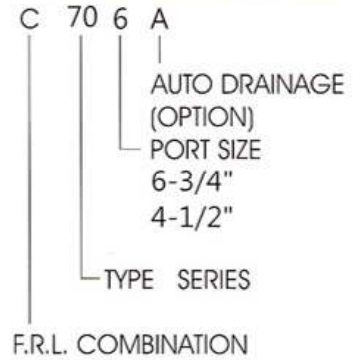

### FEATURES

- ⊙ High Air Flow design
- ⊙ High Drain Capacity
- ⊙ Water Level Indicator for visual check convenience
- ⊙ Application --- any High Flow air pressure Equipment / System

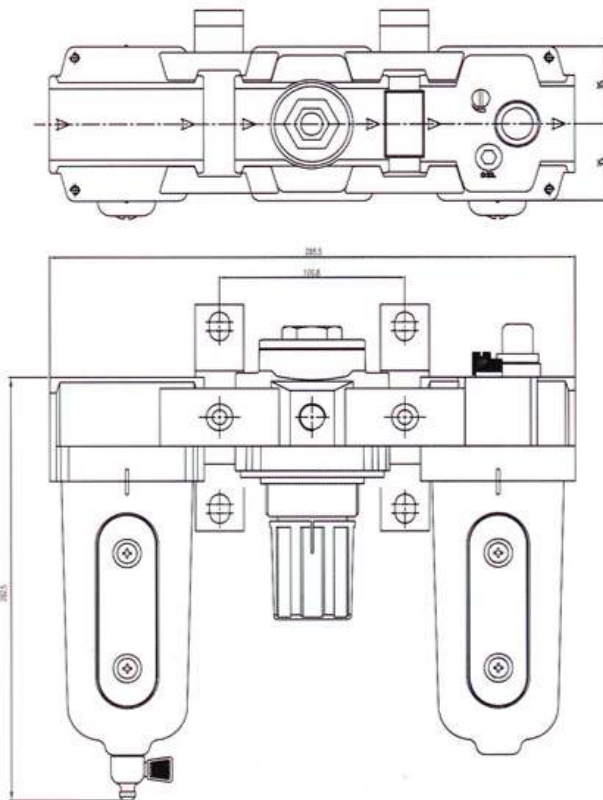

C70

# F.R.L COMBINATIONS

## SPECIFICATION



DESCRIPTION		TYPE	
		FRL706	FRL704
PORT SIZE (PT, NPT)		3/4"	1/2"
FILTER ELEMENT		5μ	
MAX INPUT PRESSURE (PSI)		250	
MAX OUTPUT PUESSURE (PSI)		7-215	
MAX FLOW (l/min)		4000	
OPERATING TEMP RANGE		5°C~60°C	
DRAIN CAPACITY		80 ml	
OIL CAPACITY		150 ml	
RECOMMENDABLE LUBRICANTS		ISO VG-32	
TYPE OF	FILTER/ REGULATOR	FR706	FR704
CONSTITUTION UNIT	LUBRICATOR	L706	L704

## ORDER EXAMPLE

FRL 70 6 - A  
 |  
 | AUTO DRAINAGE  
 | (OPTION)  
 | PORT SIZE  
 | 6-3/4"  
 | 4-1/2"  
 | TYPE SERIES  
 F/R.L. COMBINATION

## FEATURES

- ⊙ High Air Flow design
- ⊙ High Drain Capacity
- ⊙ Infix Gauge design to avoid installation interference and damage
- ⊙ Water Level Indicator for visual check convenience
- ⊙ Application --- any High Flow air pressure Equipment / System

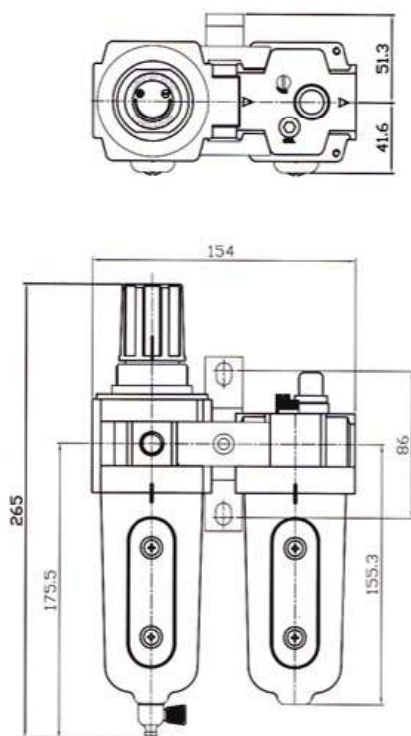

**FRL70**



**FR70**





DESCRIPTION \ TYPE		C802	C803	C804	C832	C833
PORT SIZE (PT, NPT)		1/4"	3/8"	1/2"	1/4"	3/8"
FILTER ELEMENT		5 μ				
MAX INPUT PRESSURE (PSI)		215			250	
MAX OUTPUT PUESSURE (PSI)		7~150			215	
MAX FLOW (l/min)		1750	2500	3000	1750	2500
OPERATING TEMP RANGE		5°C~60°C				
DRAIN CAPACITY		80 ml				
OIL CAPACITY		125 ml				
RECOMMENDABLE LUBRICANTS		ISO VG-32				
TYPE OF CONSTITUTION UNIT	AIR FILTER	F802	F803	F804	F832	F833
	REGULATOR	R802	R803	R804	R832	R833
	LUBRICATOR	L892	L803	L804	L832	L833

### ORDER EXAMPLE

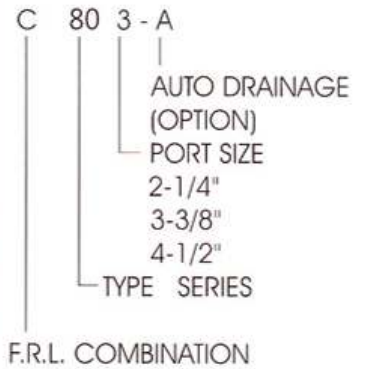

### FEATURES

- ◎ Steel Guard design for bowl protection
- ◎ Easy installation & disassembly to replacement

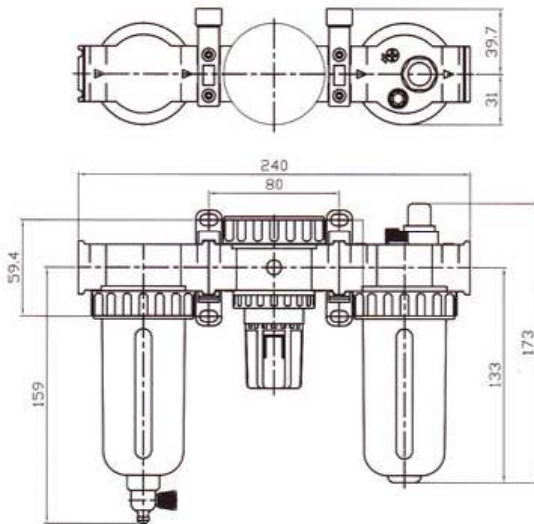

C80



### SPECIFICATION



DESCRIPTION	TYPE	
	C906A	C908A
PORT SIZE (PT, NPT)	3/4"	1"
MAX INPUT PRESSUR (PSI)	250	
MAX OUTPUT PRESSURE (PSI)	225	
MAX FLOW (l/min)	4600	5200
OPERATING TEMP RANGE	5°C ~ 60°C	
OIL CAPACITY	350 ml	
RECOMMENDABLE LUBRICANTS	ISO VG-32	
FILTER ELEMENT	5 μ	

### ORDER EXAMPLE

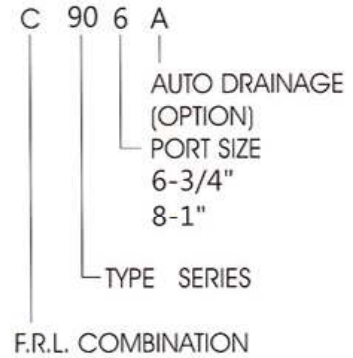

### FEATURES

- ⊙ High Air Flow design
- ⊙ High Drain Capacity
- ⊙ Water Level Indicator for visual check convenience
- ⊙ Auto Drain design
- ⊙ Application --- any High Flow air pressure & Industrial equipment / System

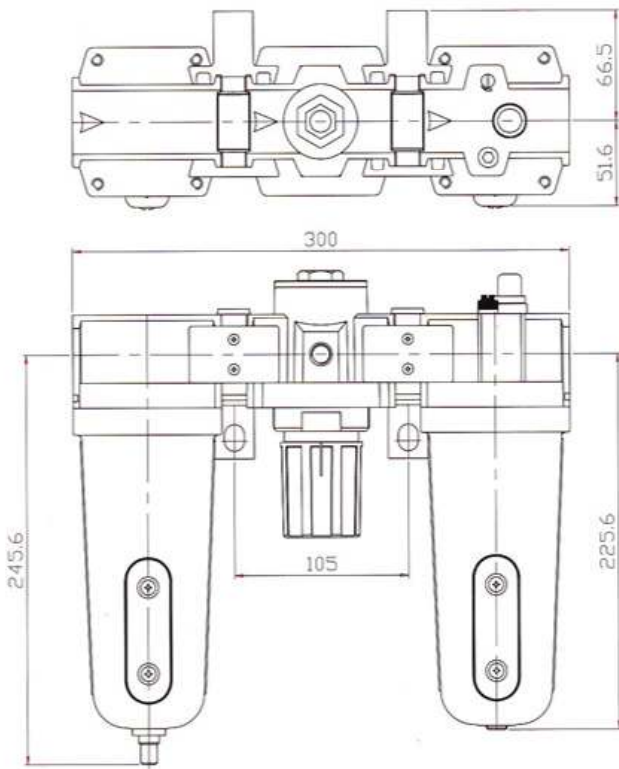

C90

# REGULATOR

## SPECIFICATION

DESCRIPTION	R10			R15			R20			R302
	R102	R112	R352	R152	R162	R182	R202	R422	R322	
PORT SIZE (NPT,PT)	1/4"			1/4" (1/8")						1/4"
MAX INPUT PRESSURE (PSI)	150	215	150	185	70	150	225	115	570	
MAX OUTPUT PRESSURE (PSI)	125	170	140	170	50	140	215	70	500	
MAX FLOW (l/min)	700			1100			2000			2000
AMBIENT TEMP	5°C ~ 60°C									
GAUGE PORT (PT,NPT)	1/8"						1/4"			



**R10**



**R15**



**R20**



**R302**